

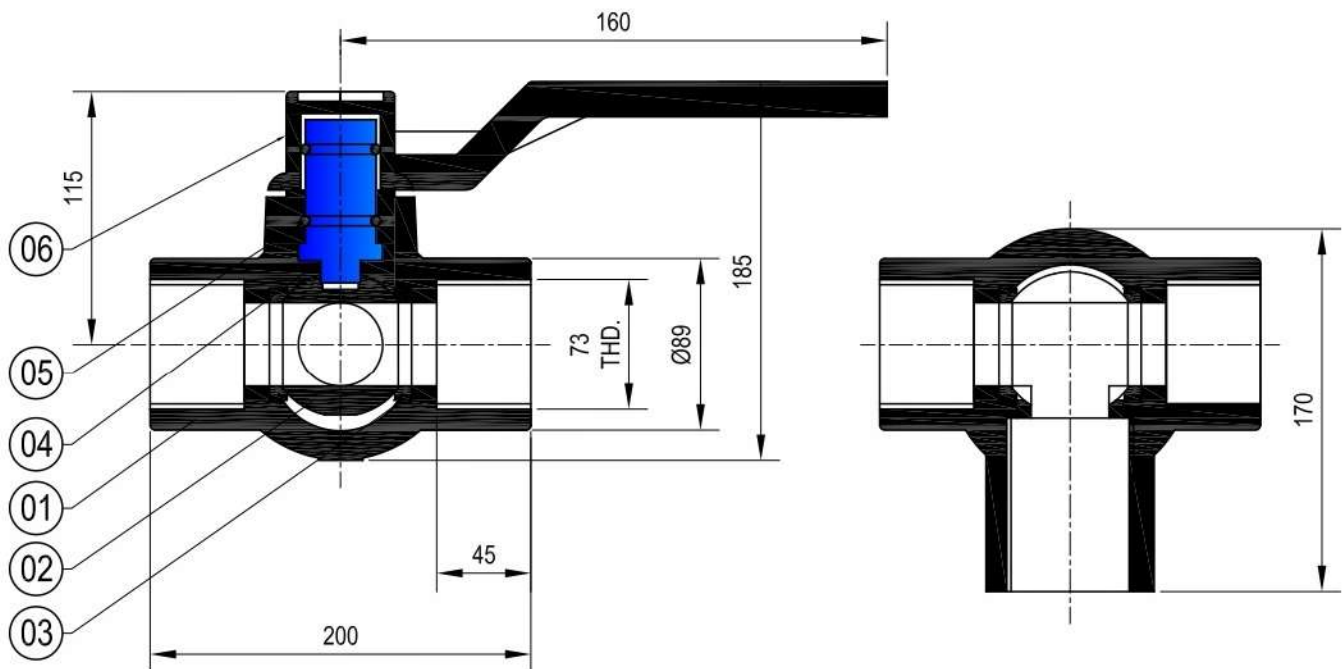

ANJALI POLYMERS

THREWAY BALL VALVE

TECHNICAL DATA	
MATERIAL OF CONSTRUCTION :	PP (POLYPROPYLENE) HDPE (HIGHDENSITYPOLYETHYLENE)
DESIGN	1 PIECE DESIGN
MAX. WORKING TEMP.	80° C (CONSISTENTLY)
END CONNECTIONS :	DIMENSION AS PER ISO-7-1 / IS-554/BS-21 - PLAIN CONNECTION REQUIRED PVC PIPE SIZE :
CONSTRUCTION	1 PIECE DESIGN, 1 PIECE STEM ,FULL BORE, TEFLON SEATED
HYDRAULIC TEST PRESSURE :	150 PSI & SEAT-100PSI
SIZE	75x2½" - 65MM
STANDARD	AS PER MANUFACTUER'S



SR NO.	DESCRIPTION	MATERIAL	QTY.
01	BODY	PP / PVDF	1
02	BALL	PP / PVDF	1
03	SEAT RING	PTFE (TEFLON)	3
04	STEM	NEOPRENE / EPDM / VITON	1
05	STEM 'O' RING	PTFE	2
06	HANDLE	POLYPROPYLENE	1

WEBSITE: www.soildballvalveindia.com

E-MAIL ID: anjali polymers2011@gmail.com

PHONE : M.94260 52921, 079-22901223



ANJALI POLYMERS

NO.61, GIRIVAR GLOBE INDUSTRIAL ESTATE, SARDAR PATEL RING
ROAD, NEAR SHREE RAM ESTATE, ODHAV, AHMEDABAD-382415,
GUJARAT, INDIA.